

LHC 650

The Leyro Portable dry well temperature calibrator suitable for temperature calibrations, between 40°C ... 650°C, offers a versatile solution for calibrating thermocouples and RTD's in industrial environments, offering an excellent performance in stability and uniformity, as well as a fast response time. The LHC 650 is easy to use, thanks to its compact and light weight design. Thanks to the large size of the insert, it has a large multi hole capacity and can calibrate a large number of thermocouples at the same time. The diameter of the Dry Block is Ø 27 mm and 165 mm of depth



APPLICATIONS

On-site calibration
Maintenance and Service
All kind of Industry
Machinery Construction

HIGHLIGHTS

Fast , Compact and Light
High Calibration Capacity
Insert Ø 27mm length 165mm
Different types of inserts exchangeable
Temperature Range: 40°C...650°C
Stability: $\pm 0,1^{\circ}\text{C}$
Warranty: 3 Years



General Information

Easy and intuitive temperature controller with 4 digits and a resolution of 0,1
Integrated TC probe for reference temperature measurements
Accuracy: $\pm 0,4^{\circ}\text{C}$
Temperature Stability: $\pm 0,1^{\circ}\text{C}$
Uniformity : $\pm 0,1^{\circ}\text{C}$



Technical Data

Operating Temperature Range(°C)	40 ... 650°C
Accuracy	± 0,4 °C
Stability:	± 0,1 °C
Resolution	± 0.1°C
Uniformity	± 0,1°C
Temperature Control	Internal TC
Calibration Volume	Ø 27mm x 165 mm (insert exchangeable)
Heating Time	From 50 to 600 °C: 20 Minutes
Cooling Time	From 600 to 100 °C 35 Minutes
Housing and assembly	Portable
Dimensions (mm)	190 x 270 x 428 mm
Weight (kg)	9 kg approx.
Supply	100 ... 234 Vac 50/60 Hz
Power Consumption	Max 800 W
Standar insert	B: 1 x Ø 3,2 / 1 x Ø 5 / 1 x Ø 6,5 / 1 x Ø 10,5
Opcional Inserts	C: 1 x Ø 6,5 / 1x Ø 12,5 D: 1 x Ø 4,5 / 1 x Ø 6,5 / 1 x Ø 10,5 E: 1 x Ø 15,7 F: 1 x Ø 17,5 G: 1 x Ø 3,2 / 1 x Ø 5 / 1 x Ø 7 / 1 x Ø 10,5 A: Blank (without holes).

Scope of delivery

Basic Instrument LHC 400
Power Cord
Standar Insert: B: 1 x Ø 3,2 / 1 x Ø 5 / 1 x Ø 6,5 / 1 x Ø 10,5
Manufacturing Traceable Calibration Certificate 5 Points
Instruction Manual
3 Years Warranty against factory defects

Optional

Communication RS 485
Trolley transport case with wheels and handle.
ISO 17025 Calibration Certificate (ENAC).
Optional Inserts: C: 1 x Ø 6,5 / 1x Ø 12,5
D: 1 x Ø 4,5 / 1 x Ø 6,5 / 1 x Ø 10,5
E: 1 x Ø 15,7
F: 1 x Ø 17,5
G: 1 x Ø 3,2 / 1 x Ø 5 / 1 x Ø 7 / 1 x Ø 10,5
A: Blank (without holes).

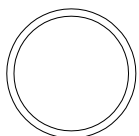

A

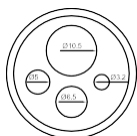

B

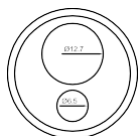

C

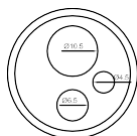

D

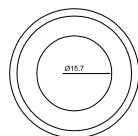

E

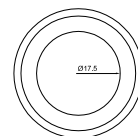

F

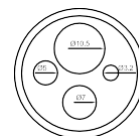

G