

LCA 30

The Leyro LCA 30 multifunction temperature calibrator is an equipment suitable for all conditions and applications, covering different kind of industries. The Leyro LCA 30 multifunction is the most advanced equipment in its class. Designed to work in a few minutes, as a dry block and as a liquid bath. Thanks to the wide variety of inserts available, it allows you to calibrate any probe or thermocouple. The LCA 30 device has a temperature range of -35°C ... 165°C *, stability of 0.01°C and accuracy of 0.1°C .



APPLICATIONS

Calibration Laboratories
 Testing Labs
 Universities / R & D
 Chemical / Pharmaceutical Industry
 Food industry
 Maintenance and Service

HIGHLIGHTS

Fast Response Time
 Temperature range -35 ... 165°C^*
 External Reference Temperature
 Immersion Depth: 190 mm
 Resolution: 0,1/0,01/ 0,001 $^{\circ}\text{C}$
 Stability: 0,01 $^{\circ}\text{C}$
 Accuracy: 0,1 $^{\circ}\text{C}$
 Uniformity: 0,05 $^{\circ}\text{C}$
 Portable
 3 Years Warranty

General Information

User interface with a touch screen of 4,3 inches
 All in one equipment (Dry Block/Liquid Bath)
 Data Register in a 80 Mb internal memory
 Function of 40 programmes
 Trend Graph
 Ethernet communication and two USB ports
 Barcode reader
 External Reference PT 100 4 Wires probe



Technical Data

Operating Temperature Range(°C)	-35...165°C*
Accuracy	0,1°C
Resolution	0.1/ 0,01/ 0,001°C
Temperature Control	Internal/ External PT100 (3/4 Wires)
Calibration Volume	Ø 60mm x 190 mm
Warm-Up time	From -5 to 100°C 25 Minutes
Cooling time	From 25 to -25°C 45 Minutes
Housing and assembly	Portable
Dimensions W x L x H (cm)	280 x 370 x 440
Weight (kg)	15.2 kg
Supply	100 ... 234 Vac 50/60 Hz
Power Consumption	Approx 310 W

LIQUID BATH**		DRY BLOCK	
Temperature Stability	±0.01 °C	Temperature Stability	0,01 °C
Uniformity	±0.05 °C / 0,09 °F	Uniformity	0,05 °C
Accuracy	0,1°C / 02°F	Insert Dimensions	59,5mm x165mm
Well capacity	0.7 liters	Standar Insert	A. 1 x Ø 3,5 /1 x Ø 6,5/ 1 x Ø 8,5/ 1 x Ø 10,5
		Optional Inserts	
		B.	2 x Ø 3,5 /2x Ø 4,5/ 2 x Ø 6,5/ 2 x Ø 8,5/ 2 x Ø 10,5
		C.	3 x Ø 3,5 /3x Ø 6,5/ 3 x Ø 8,5/3 x Ø 10,5
		D.	2 x Ø 3,5 /1x Ø 4,5/ 1 x Ø 5,0/1 x Ø 5,5/1 x Ø 6,5/ 1 x Ø 8,5 /1x Ø 9,0/ 1 x Ø 9,5/1 x Ø 10,5
		E.	Blank

*Minimum Temperature Range is 55 °C, below ambient. Absolute minimum -35°C

**It is recommended to use 10 Cst silicone oil



A

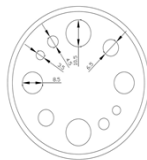

B

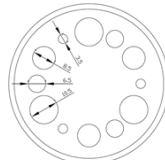

C

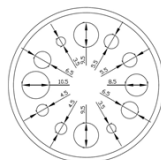

D

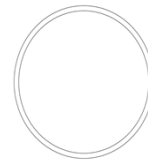

E

Scope of delivery

Basic Instrument LCA 30
Power Cord
Teflon Magnetic Stirrer
Manufacturing Traceable Calibration Certificate 8 Points
Instruction Manual
Drain Pump
3 Years of Warranty against factory defects

Options

Dry Block / Liquid Bath Function
Trolley transport case with wheels and handle
ENAC Calibration Certificate
Methacrylate lid with 6 inserts
External Control
Pt 100/ 4 Wires
Several types of inserts (See the Dry Block Tecnical Data)